



### DESCRIPTION

The Badger Meter electronic Oval Gear Meter is designed specifically to dispense industrial fluids. Modular design, low cost, light weight and rugged make the Oval Gear Meter the best choice for overhead reel systems.

The electronic register module contains a microprocessor board powered by a lithium battery with an expected life of 4 years depending on use. It can be programmed to dispense in pints, quarts, liters, or gallons. A calibration factor and unit of measure are programmed during factory test. Unlike mechanical meters, these units can be electronically recalibrated in the field when necessary.

A 6-digit liquid crystal display, accurate to the second decimal place, shows the exact amount of fluid dispensed. The entire register module is protected from the wear and tear of normal shop use by a rugged, glass filled, shock resistant, nylon housing.

### OPERATION

As fluid passes through the metering chamber by entering the inlet port, it forces the internal gears to rotate and exits through the outlet port. Each rotation of the gear displaces a given volume of fluid. Controlled clearances between the gears and chamber wall insure minimum leakage. As the gears rotate, a magnet on each end of the gear activates the microprocessor in the register. The ILR displays have a resettable and a non-resettable totalizer.



### FEATURES

- Leakproof, magnetic drive
- Large LCD display
- Three decimal point precision
- Totalization in gallons or liters
- Delivery in pints, quarts, liters or gallons
- Only two parts to reduce maintenance costs
- Accuracy to  $\pm 0.5\%$  (linearisation possible)
- About 4 years battery life
- Low battery indicator
- Replaceable battery
- Humidity and moisture resistant register
- Two year limited warranty



## DIMENSIONS

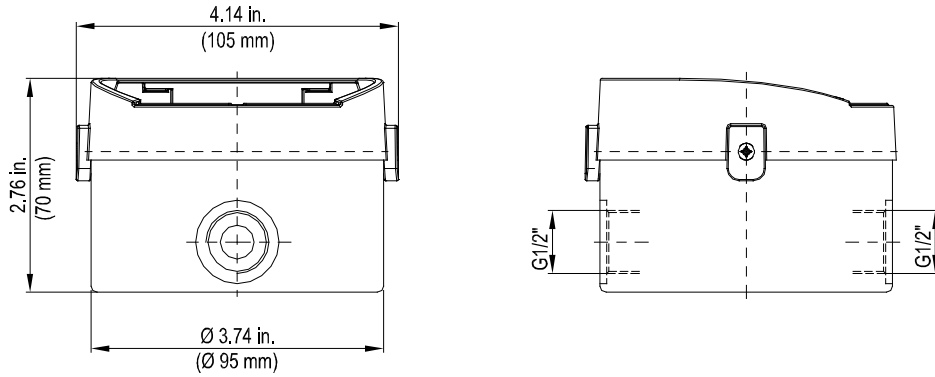

## TECHNICAL DATA

	ANSI	Metric
<b>Maximum flow *</b>	8 gpm	35 l/min
<b>Minimum flow *</b>	0.13 gpm	0.5 l/min
<b>Operating pressure (maximum)</b>	145 psi	10 bar
<b>Operating pressure (minimum)</b>	4.5 psi	0.30 bar
<b>Operating temperature (maximum)</b>	110° F	45° C
<b>Operating temperature (minimum)</b>	-14° F	-10° C
<b>Accuracy (non-approved version) at viscosity &gt; 5cP</b>	±0.5%	±0.5%
<b>Accuracy (non-approved version) at viscosity &lt; 5cP</b>	±1.0 %	
<b>Weight, less handle</b>	2.5 lbs	1.0 kg
<b>5-digit LCD display, 5/16" high (8 mm)</b>	Pints-Quarts-Gallons	Liters
<b>Inlet &amp; outlet connections</b>	1/2" BSPP	1/2" BSPP
<b>Max. torque</b>	8 Nm	8 Nm

\*Tested with water at ambient temperature.

Materials	
Internal gears	LCP – Plastic (Vectra)
Bottom / axial	SS 1.4301
Housing	PVC

Please ensure that the fluid is properly filtered before entering meter. Foreign particles will cause inaccuracy as well as malfunction of the meter.

## Control. Manage. Optimize.

Trademarks appearing in this document are the property of their respective entities. Due to continuous research, product improvements and enhancements, Badger Meter reserves the right to change product or system specifications without notice, except to the extent an outstanding contractual obligation exists. © 2020 Badger Meter, Inc. All rights reserved.

[www.badgermeter.com](http://www.badgermeter.com)